

Brisbane Boutique Property



21308/19 Wilson Street West End QLD

1 1 1

UNDER CONTRACT - OPEN HOMES CANCELLED -
Sitting on the 13th floor of Building 2 "Lexington" in the infamous "West Village" at West End sits this gorgeous 1 Bedroom + Study unit, with 1 Bathroom and 1 Car accommodation.

Offering luxurious fixtures and fittings, an 11m2 balcony with privacy assured but look left and see beautiful views across to Mount Cootha, and look right and see over South Brisbane to the city and the new Queens Wharf precinct. The artistic design of the complex displays Bromley art adorning the halls, foyer's and common area's, a true joy to come home too, and a great place to entertain guests in a myriad of common area facilities.

Sitting only 1.5ks from the city, right smack bang in the heart of the beautiful, culturally diverse suburb of West

Building Size : 75 sqm
View : <https://www.brisbaneboutique.com/sale/qld/inner-south/west-end/residential/apartment/7878834>



Pelham Marsh
3169 0230



GARAGE LEVEL

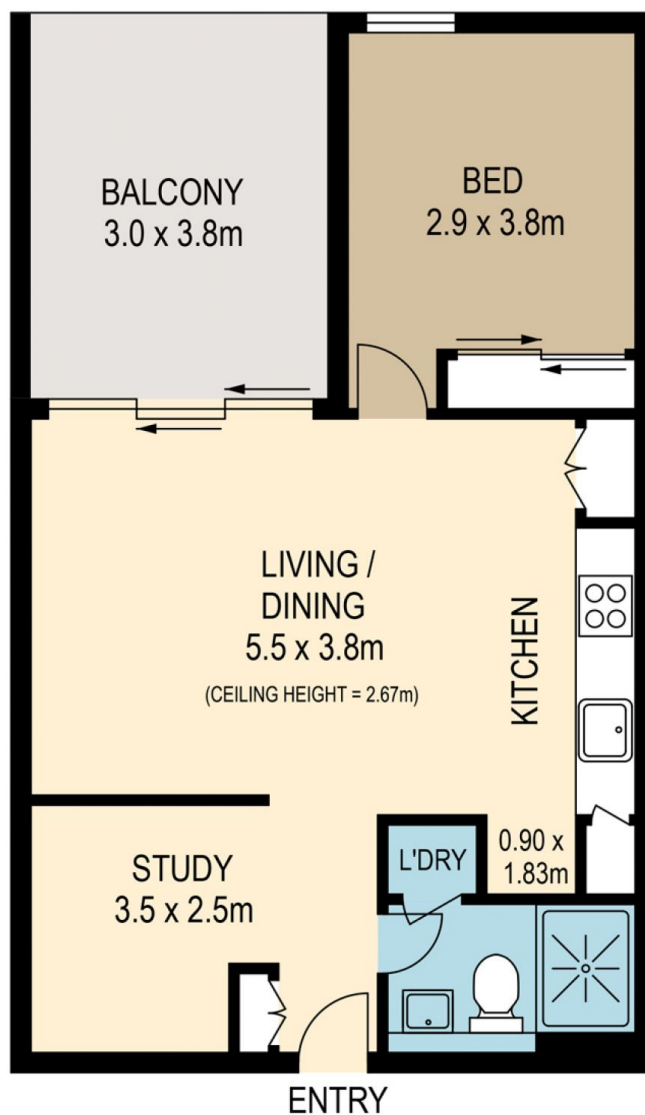

APARTMENT LEVEL



SCALE (METRES)

PLANS SHOWN ONLY INDICATIVE OF LAYOUT. DIMENSIONS ARE APPROXIMATE.

All information contained herein is gathered from sources we believe to be reliable.
However we cannot guarantee its accuracy and interested persons should rely on their own enquiries.

apartment	50sqm
balcony	11sqm
garage	14sqm
total	75sqm



21308-19 WILSON STREET

Created by RealScope©
www.realscope.com.au