

Brisbane Boutique Property



43 Horsington Street Morningside QLD

3 1 2

Sitting high on the hill looking north towards the the Gateway Bridge is this quaint Beautifully renovated Queenslander. Offering 3 decent sized bedrooms, a study, 1 modern bathroom, a renovated up to date kitchen with stainless appliances, high ceilings, period features with polished hardwood floors, big front and side decks, and a double lock up garage.

Situated on a corner high above the street this home receives great bay breezes. The massive side deck looks over the suburbs towards the bay. The home seamlessly melds the beautiful period features you would expect in a home of this age with the modern amenities we all expect and enjoy.

This is an ideal home for a professional couple or a family with older children. It has a beautiful feel when entering this

View : <https://www.brisbaneboutique.com/lease/qld/inner-south/morningside/residential/house/6262713>



Pelham Marsh
3169 0230

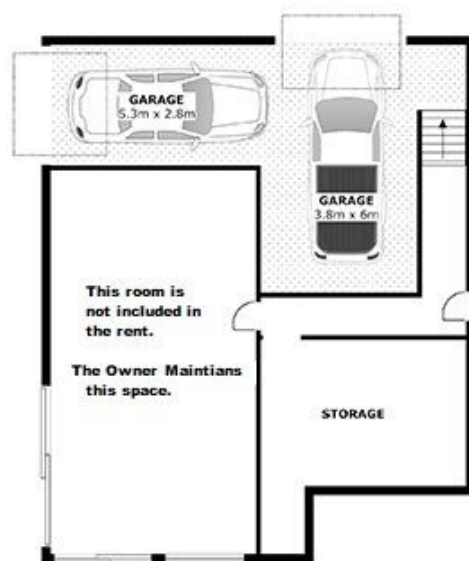

LOWER LEVEL



HIGHER LEVEL

APPROX GROSS INTERNAL AREA 223 sqm

APPROX GROSS TOTAL AREA 263 sqm

Whilst every attempt has been made to ensure the accuracy of the floorplans contained here, measurements of doors, windows and rooms are approximate and no responsibility is taken for any error, omission or misstatement. These plans are for representation purposes only.

1/43 HORSINGTON ST, MORNINGSIDA QLD