

# Brisbane Boutique Property



## 16 Glen Street Coorparoo QLD

4 🏠 2 🚗 4 🚗

UNDER APPLICATION - Practical, Spacious, Enticing and luxurious are the words that come to mind when entering this beautiful home. Situated In a highly desirable enclave that backs onto an exclusive use parkland that is only accessible by the 16 residents that live on the park.

Quiet and safe make this Ideal for raising a family. This beautifully presented 4 Bedroom, 2 bathrooms home (albeit Bedroom 4 is small) sits on 534m<sup>2</sup> of Residential A land and has views over a magnificent parkland. This home is in what I consider to be one of the best family locations on offer in Coorparoo, you will feel appreciative and relaxed as you enjoy the serenity of the neighbourhood.

Offering 4 bedrooms all with built in robes, a master bedroom with an ensuite, 2 modern high end bathrooms (Inc Ensuite), beautiful honey pine polished floors to the

**Building Size** : 197 sqm  
**Land Size** : 534 sqm  
**View** : <https://www.brisbaneboutique.com/lease/qld/southside/coorparoo/residential/house/6262694>



**Pelham Marsh**  
3169 0230

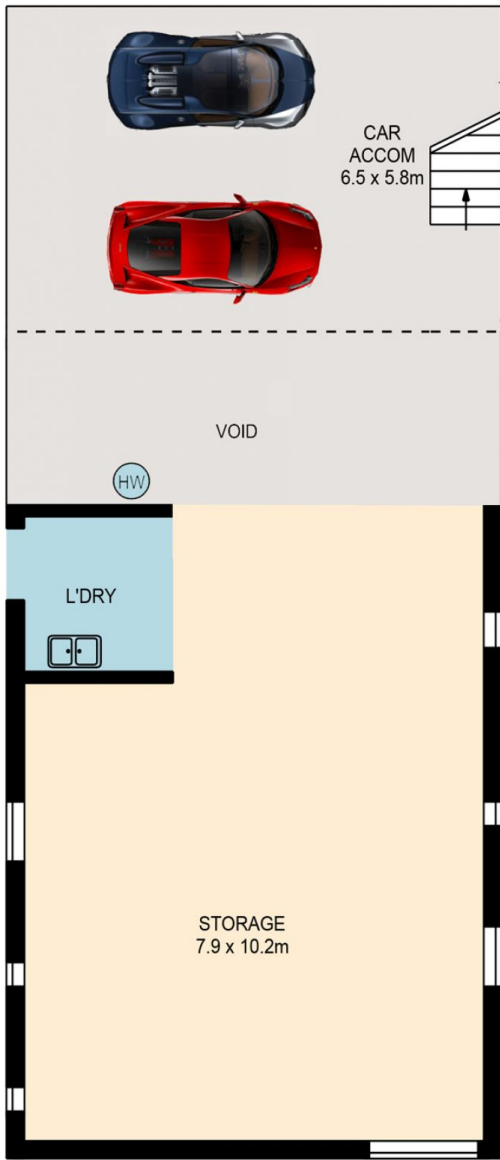

LOWER LEVEL

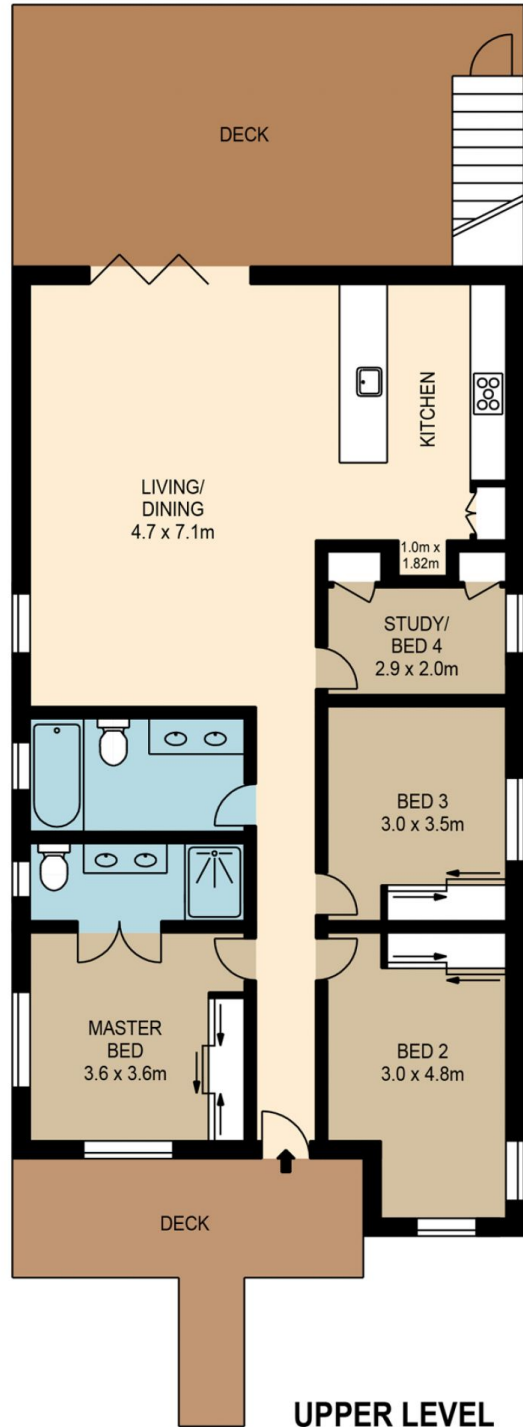

UPPER LEVEL



PLANS SHOWN ONLY INDICATIVE OF LAYOUT. DIMENSIONS ARE APPROXIMATE.

All information contained herein is gathered from sources we believe to be reliable. However we cannot guarantee its accuracy and interested persons should rely on their own enquiries.

	internal	external
lower	82 sqm	73sqm
upper	115sqm	51sqm
total	197sqm	124sqm



16 GLEN STREET

Created by RealScope®  
www.realscope.com.au